

USO Existing vs. Proposed

Item No. 6d_Attach 2
Date of Meeting June 25, 2013

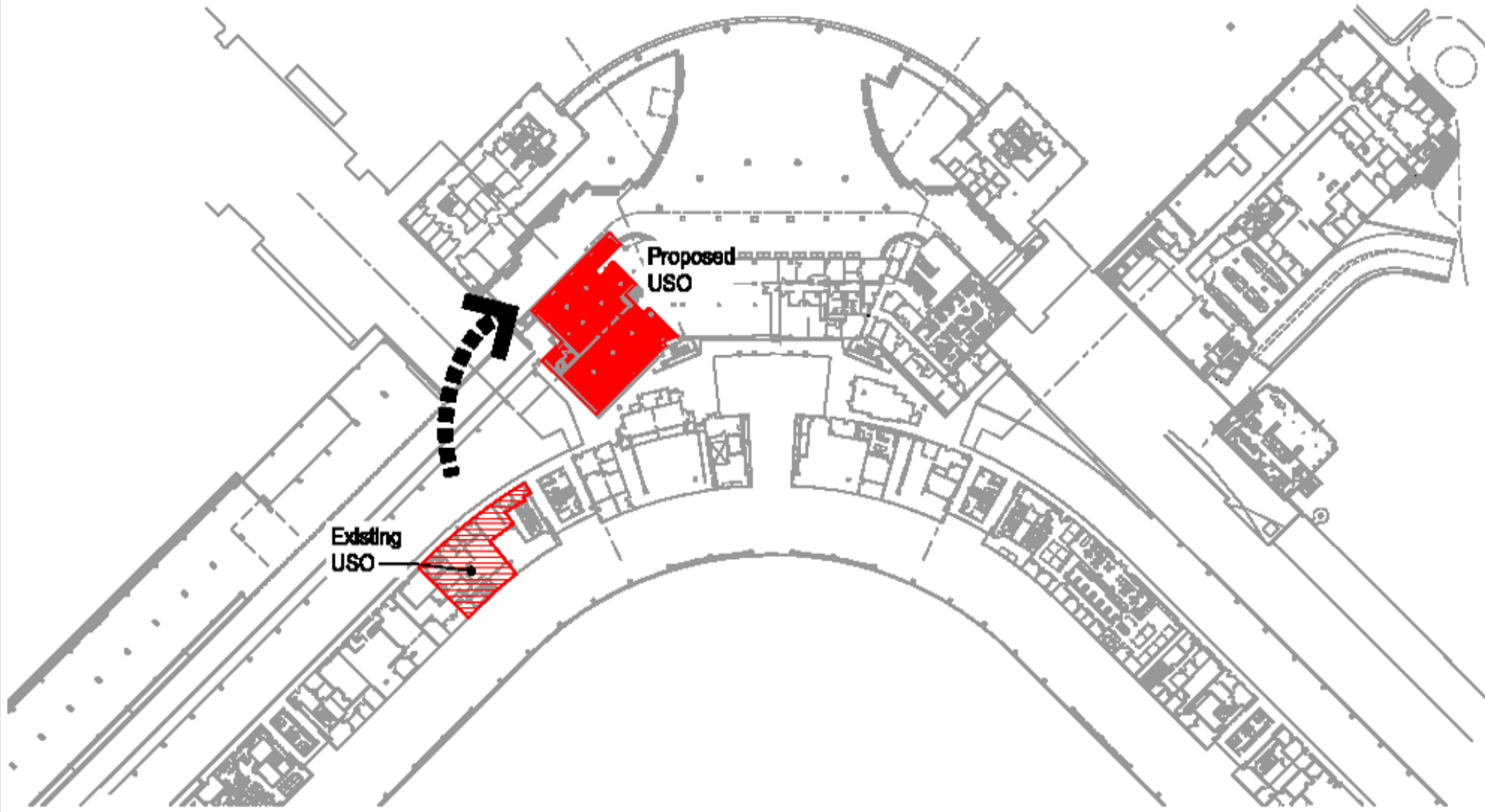

Existing USO - 3,410 SF
Proposed USO - 7,000 SF

Existing
USO

Proposed
USO

Port of Seattle/Aviation Properties
Seattle-Tacoma International Airport

DATE	
SCALE	
PROJECT NO.	
ISSUE NO.	
ISSUE DATE	
ISSUE NO.	2



\\AURUS2805\Aviation\AV-Preperties\01_PRO\pwr\USO\USO Relocation Project.dwg May 25, 2013 - 1:14pm